

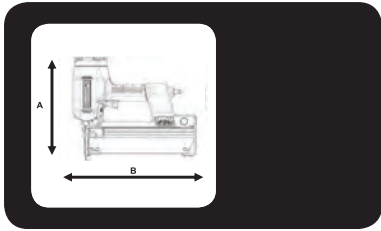

haubold®

PN9180XII





PN9180XII

| | | |
|--|--|---|
| | | L = 371 mm H = 297 mm W = 101 mm |
| | | |



| |
|----------------------------------|
| <p>Min. 6 bar Max. 8 bar</p> |
| <p>1,6 l (6 bar) / </p> |
| <p>Ps max. = 8 bar</p> |

| | |
|---|---|
| <p>EN 12549+EN ISO 4871</p> | <p>LWA.1s = 109 dBA LpA.1s = 104 dBA LpA.1s1M = 96 dBA</p> |
| <p>EN 12096 : 1997</p> <p>ISO 8662 - 11</p> | <p>Vibration = 2,6 m/s⁻²</p> |

| | | |
|---------------------|--|--|
| <p>116 x 129 = </p> | | <p>SD 9100 d = 2 mm B = 11,8 mm</p> <p>HD7900 d = 1,8 mm B = 11 mm</p> |
| <p>116 129</p> | <p>SD 9100 HD 7900</p> | <p>L = 50 - 80 mm L = 50 - 75 mm</p> |





| | |
|---|---|
|  | Sequential trigger actuation/ Einzelauslösung/ enkelschots/ Déclenchement du tir - mode séquentiel/ Funcionamiento secuencial "en continuo"/ Gatilho de actuação sequencial/ funzionamento sequenziale (colpo a colpo)/ Enkeltskuds aftrækker/ Enkeltskott/ Enkeltskudds avtrekker/ Kertalaukaisu/ Üksiklasu meetodil töötamine/ Uruchromienie spustu sekwencyjne/ Sekvenčni spoušť/ Egyes lövés (szakaszosan működtetett elsütő billentyűvel)/ Posamezno proženje/ Kontaktirajte singl / Последовательная активация при нажатии на курок/ Sekvenčná aktivácia spúšte/ التشغيل بالزر التسلسلي المقيد / Nuoseklusis paleidimo mechanizmas/ Sekvencialās palai des iedarbināšana Raðkveikjvirkjun |
|---|---|

| | |
|--|---|
|   | Contact trigger actuation/ Kontaktauslösung/ repeterend schieten/ Déclenchement du tir - mode rafale/ Funcionamiento por contacto "clavo a clavo"/ Gatilho de actuação por contacto/ funcionamiento a contatto/ Støtskydning's aftrækker/ Støtskjutning/ Støtspikrings avtrekker/ Kosketuslaukaisu/ Automaatmeetodil töötamine/ Uruchromienie spustu przez kontakt/ Kontaktní spoušť/ Sorozatlövés (folyamatosan behúzott elsütő billentyűvel)/ Kontaktno proženje/ Kontaktirajte pokretanje/ Контактная активация при нажатии на курок/ Kontaktná aktivácia spúšte/ التشغيل بتلامس الزر / Kontaktinis paleidimo mechanizmas/ Kontakta palai des iedarbināšana/ Snertikveikjvirkjun |
|--|---|

| | | |
|---|---|---|
| <p>Model: PN9180XII Contact Euro Code: 503839</p> |  |  <p>PN9180XII PNEUMATIC STAPLER / Code : 503839 Trigger Actuation : Contact STAPLE SPECIFICATION SD 9100 • HD7800</p>  |
|  | | |

| | | |
|---|---|---|
|  |  |  |
| No. 014748 + No. 577027 | | No. 035110 |

Accessories

| | |
|---|---|
|  |  |
| No. 151299 / No. 576216 | |
| 0,5 l oil / 1 l oil | |

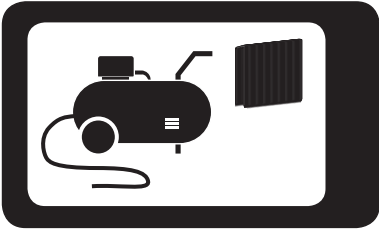

014 748

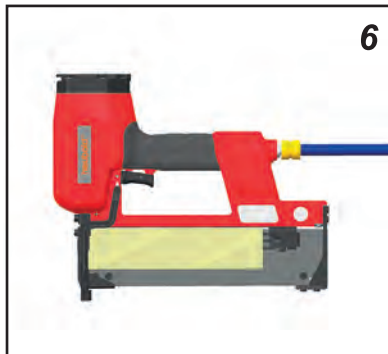
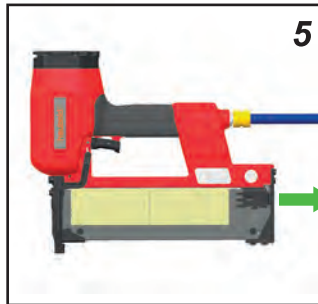
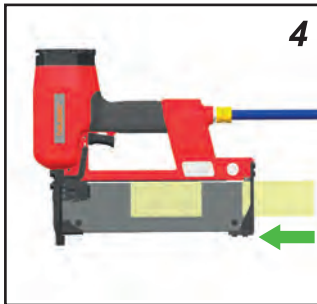
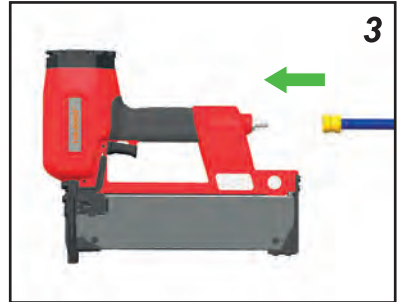
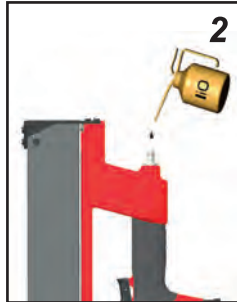
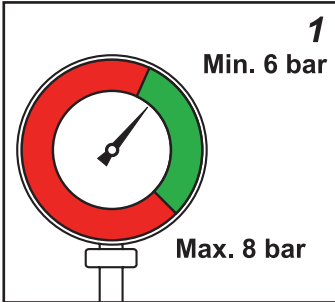

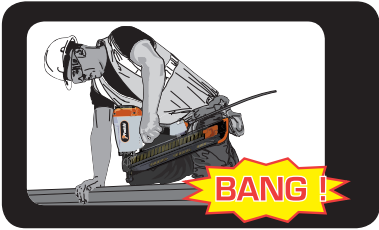

014 748

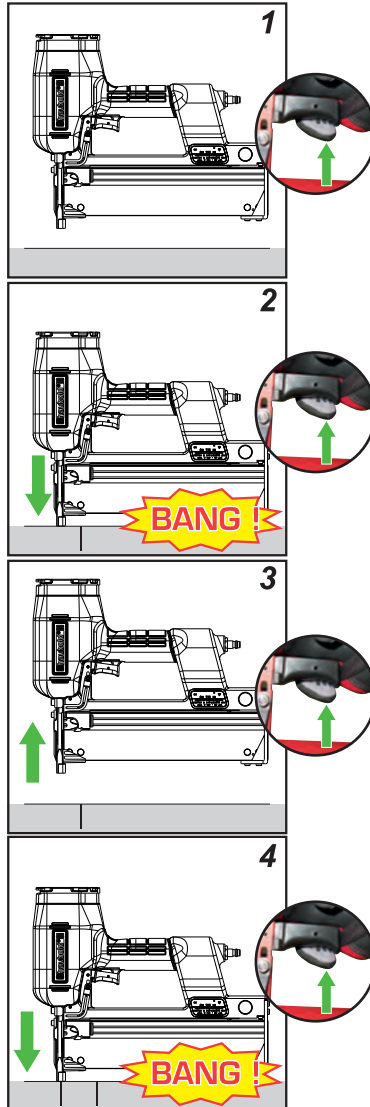

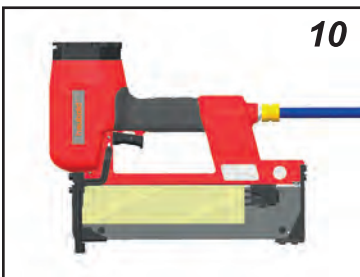
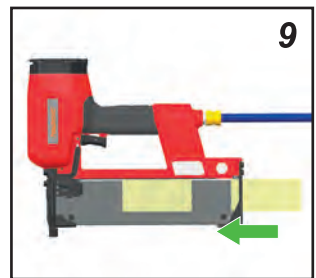
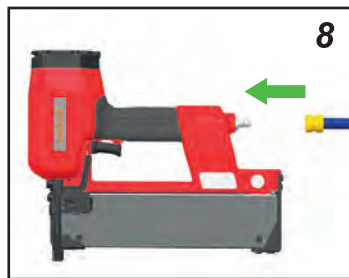
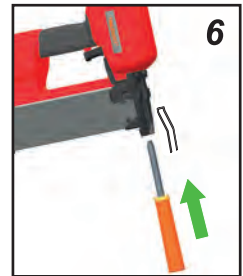
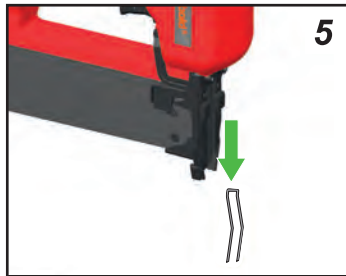
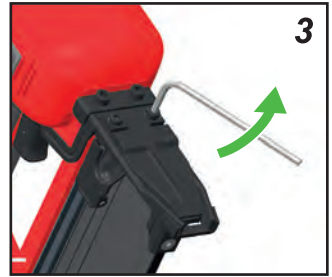
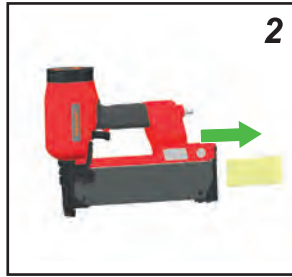
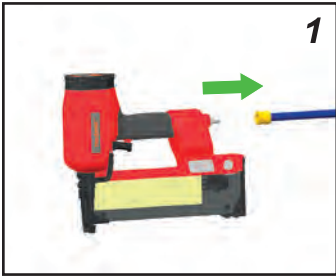
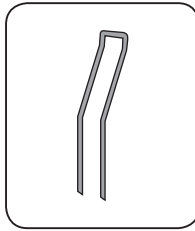

YY/WW....

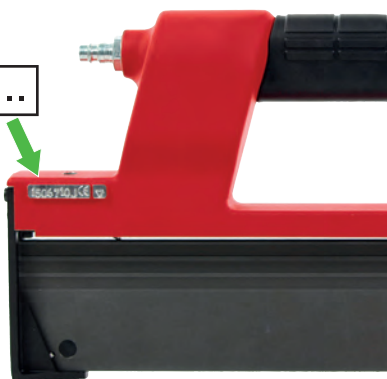

YY= Year of manufacture
WW = Week of manufacture

**Resting position/ Ruheposition/ Position de repos/ Ruststand/
Posición de descanso/ Posizione di riposo/ Posição de des-
canso/ Pozycja spoczynku/ Klidová poloha/ Nyugalmi állapot/
Положение в нерабочем состоянии/ Θέση αδράνειας/ Hvile-
tilling/ Viloläge/ Hvileposisjon/ Lepoasento/ Položaj mirovanja/
Pokožová poloha/ Položaj mirovanja/ وضع السكون / Ramybės
padėtis/ Ooteasend/ Miera stāvoklis/ Hvíldarstaða**



NOTES



haubold[®]

ITW CONSTRUCTION PRODUCTS EUROPE
Code 577027 (05/2019)
www.spitpaslode.com