

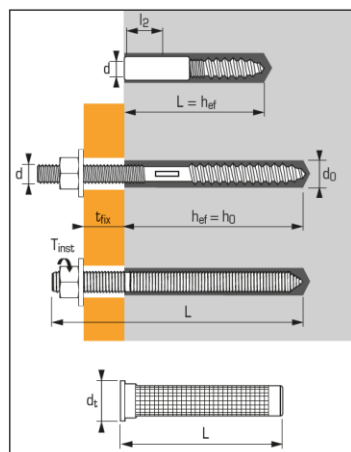

## Approved Polyester Resin for fixing in concrete and hollow and solid masonries



### Technical data

Anchor size		Min. anchor depth (mm) h <sub>ef</sub>	Max. thick. part to be fixed (mm) t <sub>fix</sub>	Thread Ø (mm) d	Thread length (mm) l <sub>2</sub>	Sleeve Ø (mm) d <sub>t</sub>	Thread Ø		Drilling depth		Total anchor length (mm) L	Tighten torque (Nm) T <sub>inst</sub>	Code
							hollow (mm) d <sub>o</sub>	solid (mm) d <sub>o</sub>	hollow (mm) h <sub>o</sub>	solid (mm) h <sub>o</sub>			
BARRA LEGNO	M8X100	75	12	8	-	-	15	10	80	75	100	5	061650
	M10X100	75	20	10	-	-	15	12	80	75	100	8	061660
	M12X100	75	20	12	-	-	20	14	80	75	100	8	061670
BUSOLA FEMMINA	M8X58	58	-	8	20	-	20	14	80	58	58	8	061740
	M10X58	58	-	10	23	-	20	14	80	58	58	8	061750
	M12X75	75	-	12	23	-	20	20	100	75	75	8	061760
BUSOLA RETINATA	Ø15X85	-	-	-	-	15	15	-	85	-	85	-	061600
	Ø20X85	-	-	-	-	20	20	-	90	-	85	-	061490
	Ø15X130	-	-	-	-	15	20	-	135	-	130	-	557080
BARRA FIL METRICA	M8X110	80	15	8	-	-	-	10	-	80	110	10	050950
	M10X130	90	20	10	-	-	-	12	-	90	130	20	050960
	M12X160	110	25	12	-	-	-	14	-	110	160	30	050970
	M16X190	125	35	16	-	-	-	18	-	125	190	60	050980
CMIX PLUS EVO Polyester resin (grey) 410 ml + 2 mixer													565136
CMIX PLUS EVO Polyester resin (grey) 300 ml + 2 mixer													565135

### APPLICATION

- Signs
- Scaffolding
- Electrical switchboards
- Radiators
- Air conditioning ducts
- Rail guard returns
- Blinds
- Climbing walls
- Metal scale
- Hand rails
- Pole and ducts
- Demountable partitions
- Kitchen furniture
- Decorations

(1) Plastic sleeve Ø15X85 for male studs M8 and M10 in hollow material.

Plastic sleeve Ø20X80 and Ø20X85 for male studs M12 and female studs M8, M10 and M12 in hollow material. Plastic sleeve Ø15X130 for threaded stud M8X170 - Using standard threaded rods.

### Setting time

Temperature	Max. time for installation	Curing time
30°C > T ≥ 40°C	3 min	20 min
20°C > T ≥ 30°C	5 min	30 min
10°C > T ≥ 20°C	9 min	60 min
0°C > T ≥ 10°C	20 min	90 min
-5°C > T ≥ 0°C	40 min	180 min

### Recommended loads (Nrec, Vrec) in concrete C20/25 in kN\*

#### TENSILE

Anchor size	M8*	M10*	M12*	M16*
Nrec	4,48	6,30	9,25	14,00

\* threaded stud

Anchor size	M8*	M10*	M12*	M16*
Minimum spacing distances (mm)				
Smin	160	180	220	250
Cmin	80	90	110	125

\* For detailed and right calculation, and M6 loads, see ETA assessment

#### SHEAR

Anchor size	M8*	M10*	M12*	M16*
Vrec	2,85	4,60	6,65	12,60

\* threaded stud

### INSTALLATION

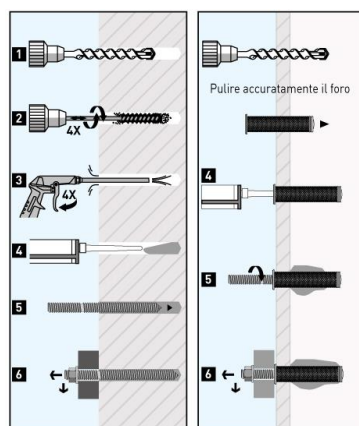

### Recommended loads (Nrec, Vrec) in masonries in kN

#### TENSILE

Anchor size	Sleeve + male stud			Sleeve + female stud			Sleeve Ø15X130	
	M8	M10	M12	M8	M10	M12	+ Stud	M8
Solid clay bricks BP 400								
Nrec	1,3			1,3			-	
Solid concrete blocks B 80								
Nrec	5,0			5,0			-	
Hollow clay bricks C 40 rendered								
Nrec	1,0			1,0			0,6	
Hollow clay bricks C 40 not rendered								
Nrec	0,6			0,6			0,6	
Solid clay masonry Mattone pieno UNI **								
Nrec	1,0			-			-	
Hollow clay brick Doppio UNI**								
Nrec	0,4			-			-	

#### SHEAR

	Sleeve + male stud			Sleeve + female stud			Sleeve Ø15X130 +Stud M8
	M8	M10	M12	M8	M10	M12	
V <sub>rec</sub>	1,8	2,5	4,0	2,0	2,5	4,0	-
V <sub>rec</sub>	1,8	2,2	3,2	1,8	2,2	3,2	-
V <sub>rec</sub>	2,0			2,0			2,0
V <sub>rec</sub>	1,3			1,3			1,3
V <sub>rec</sub>	1,71			-			-
V <sub>rec</sub>	0,57			-			-

\* Sleeve Ø15X130 + threaded stud M8X170

\*\* For detailed and right calculation, see ETA assessment

\*\* For M6 loads, see ETA assessment